

WEST RESERVOIR LANDSCAPE

LANDSCAPE OVERVIEW - PLAN & DESCRIPTIONS

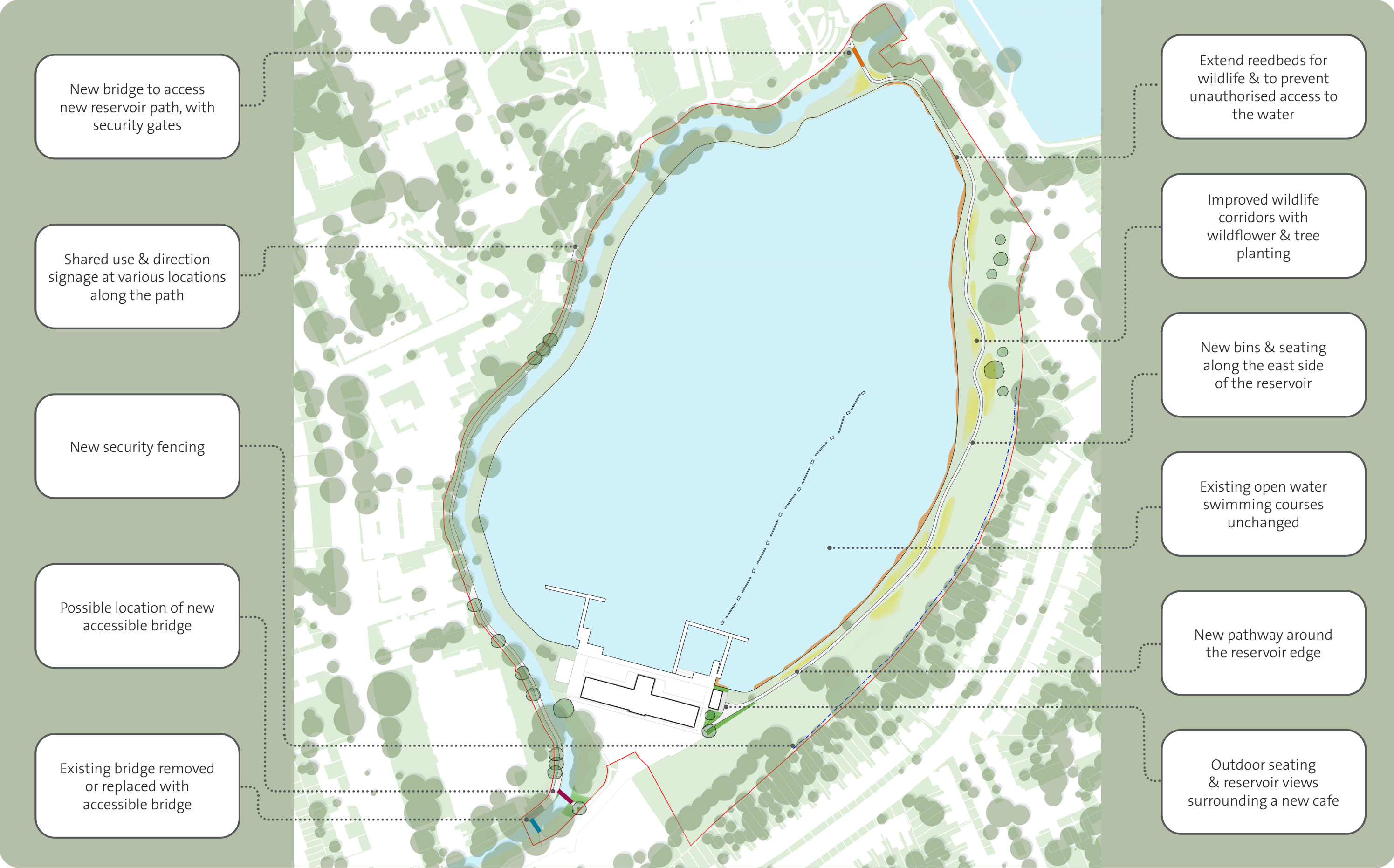

WEST RESERVOIR LANDSCAPE

LANDSCAPE OVERVIEW - EXAMPLE IMAGES



New bridge access to reservoir path, with accessibility & security considerations



Finger posts providing directions



Subtle incidental play elements



Extended & improved reedbeds



New accessible bridges



New tree planting for wildlife



Wildflower seeding to waters edge



Bench with back & armrests

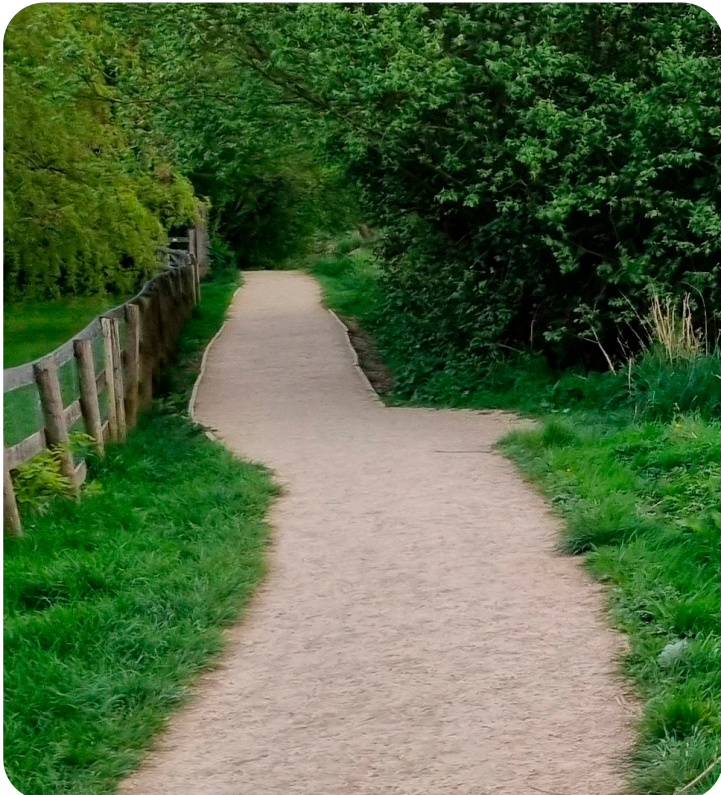

New pathway along the east side of the reservoir

WEST RESERVOIR LANDSCAPE

NEW ACCESSIBLE BRIDGE - POSSIBLE LOCATIONS & EXAMPLES

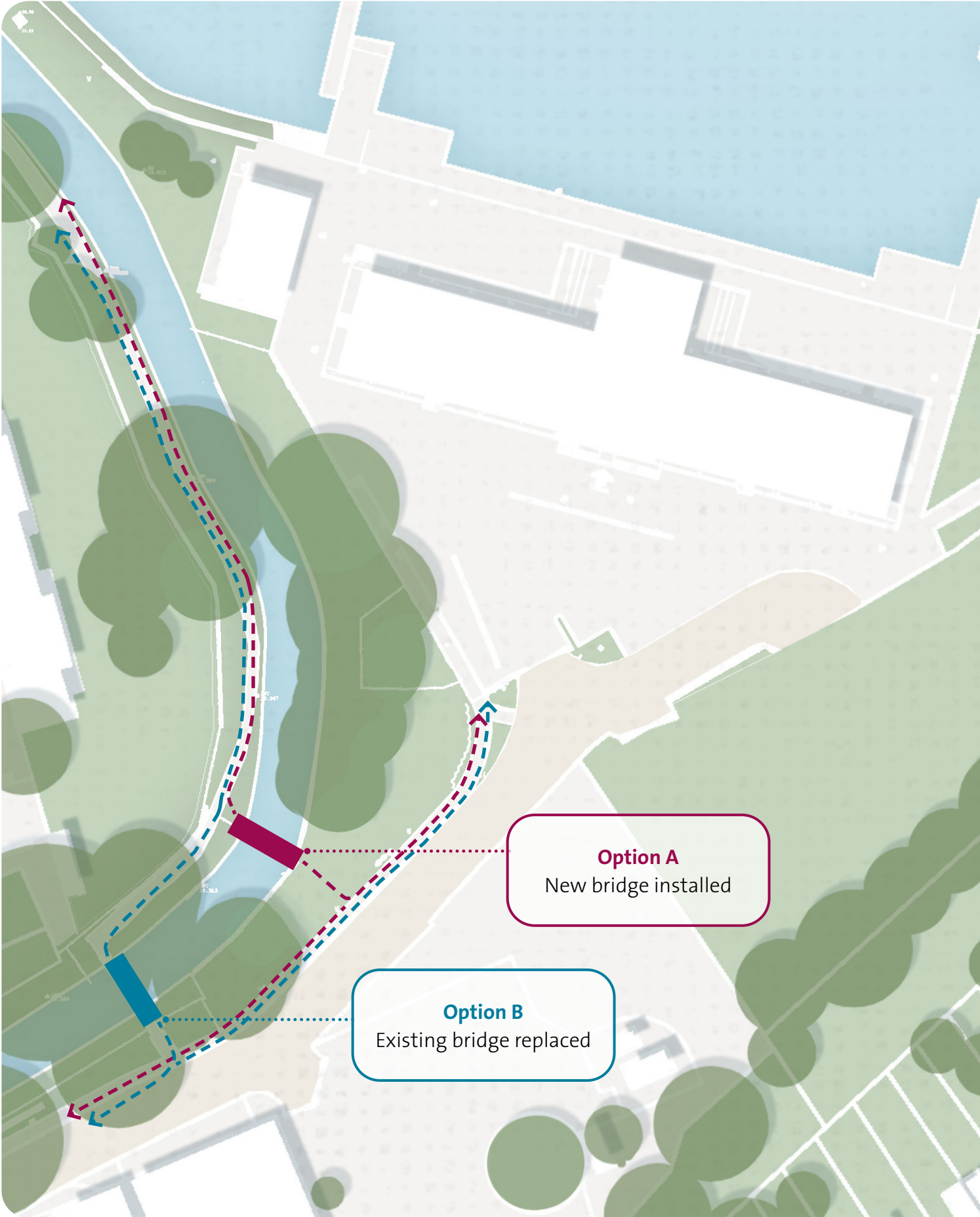

Option A

New bridge installed

Positives

- This would utilise space on either side of the banks outside tree root protection areas
- This would avoid having to build a ramp around an existing tree
- It would be cheaper to build and easier to maintain because of the above reasons
- It would set aside a small section of land for 'wildlife only'
- As it is within close proximity to existing bridge, it can still be deemed to retain the status quo

Negatives

- The route is located approximately 30m up river from the existing bridge location, and some minor works to connect better with the road may be needed

Option B

Existing bridge replaced

Positives

- Replacing the existing bridge would be simple in terms of planning and retaining the status quo
- A new accessible bridge would be in a location that everyone already knows

Negatives

- A large extra area of ramped decking would be required to ramp up around an existing tree
- Works either side of the bank would be needed within the tree root protection areas of many trees
- A large area of ramped decking and construction works within tree root protection areas have much larger cost implications
- The route is not so convenient for access to the West Reservoir site and café
- This option doesn't allow for a new 'wildlife only' space