



Brooke Road Junction With Evering Road

Proposed road safety scheme

Public consultation
January 2020



Help us to improve the junction of Brooke Road and Evering Road

Why are these changes being proposed for this junction.

The Council is committed to making our roads safer for everyone living, working and visiting the borough. These changes aim to create an environment that will encourage more walking and cycling, improve air quality and reduce emissions within the local area. Our Transport Strategy includes a Liveable Neighbourhoods Plan, which recognises that local streets are not just places to park vehicles or drive, walk and cycle on. They are places where we socialise and live our lives. An aspiration is to reclaim our streets from motor traffic congestion and transform them into the most attractive and liveable neighbourhoods in London.

Encouraging the use of cleaner and greener transport options (particularly walking, cycling and public transport) and reducing non-essential private car journeys are key long-term objectives for the Council due to the wide range of benefits these transport options can bring, including:

- Reducing potential road accidents
- Improving personal mobility
- Creating safer, cleaner, and quieter residential neighbourhoods

There were 9 reported accidents at the junction from January 2015 to December 2018. 5 of which were as result of Brooke Road traffic failing to give way. The Council has received a number of requests from residents and stakeholders to improve road safety at the junction of Brooke Road and Evering Road.

Overview

The junction is very busy with traffic ‘rat running’ to avoid congestion along Upper Clapton Road, Stoke Newington High Street and Northwold Road. The long straight and open nature of Evering Road encourages high vehicular speeds, in particular, through the junction.

The current street layout of the junction includes a 3-stage crossing, resulting in excessive pedestrian crossing distances and away from desired walking lines. The street surroundings are also dominated by excessive street furniture contributing to a vehicle dominated environment. Please see photos below.

There is a primary school and a nursery nearby, and the wide layout of the junction makes it difficult for parents and children to cross. The extra space here could be used to improve the junction environment whilst reducing traffic speeds and improving road safety.

What we intend to do

Funding has now become available and, as a result, we are proposing to redesign the junction and adjacent areas to make the space safer and attractive for all users.

The proposed staggered junction layout aims to make the junction safer by reducing traffic speeds and the crossing distances. Both Brooke Road and Evering Road will be narrowed at the junction encouraging vehicles to pass at lower speeds. Please see the plan attached.

Crossing points for pedestrians, aligned with the desired walking lines, will be made easier by shorter crossing distances between the footways and improved sight lines.

The road width is to be reduced by widening the footways into the road. The existing slip road on Brooke Road will also be removed and this will create a new public realm space displaying new trees, soft landscaping and incorporating SuDS - Sustainable Urban Drainage Systems. These features will improve how the area looks and reduce traffic dominance of this residential area.

Overall, there will be a net loss of five parking spaces, as this will allow for the creation of new landscaped areas, wider footways and the introduction of an electric vehicle charging point. Double yellow lines are proposed around the new build-outs and at the junction to remove parking and improve sight lines for pedestrian crossing points.

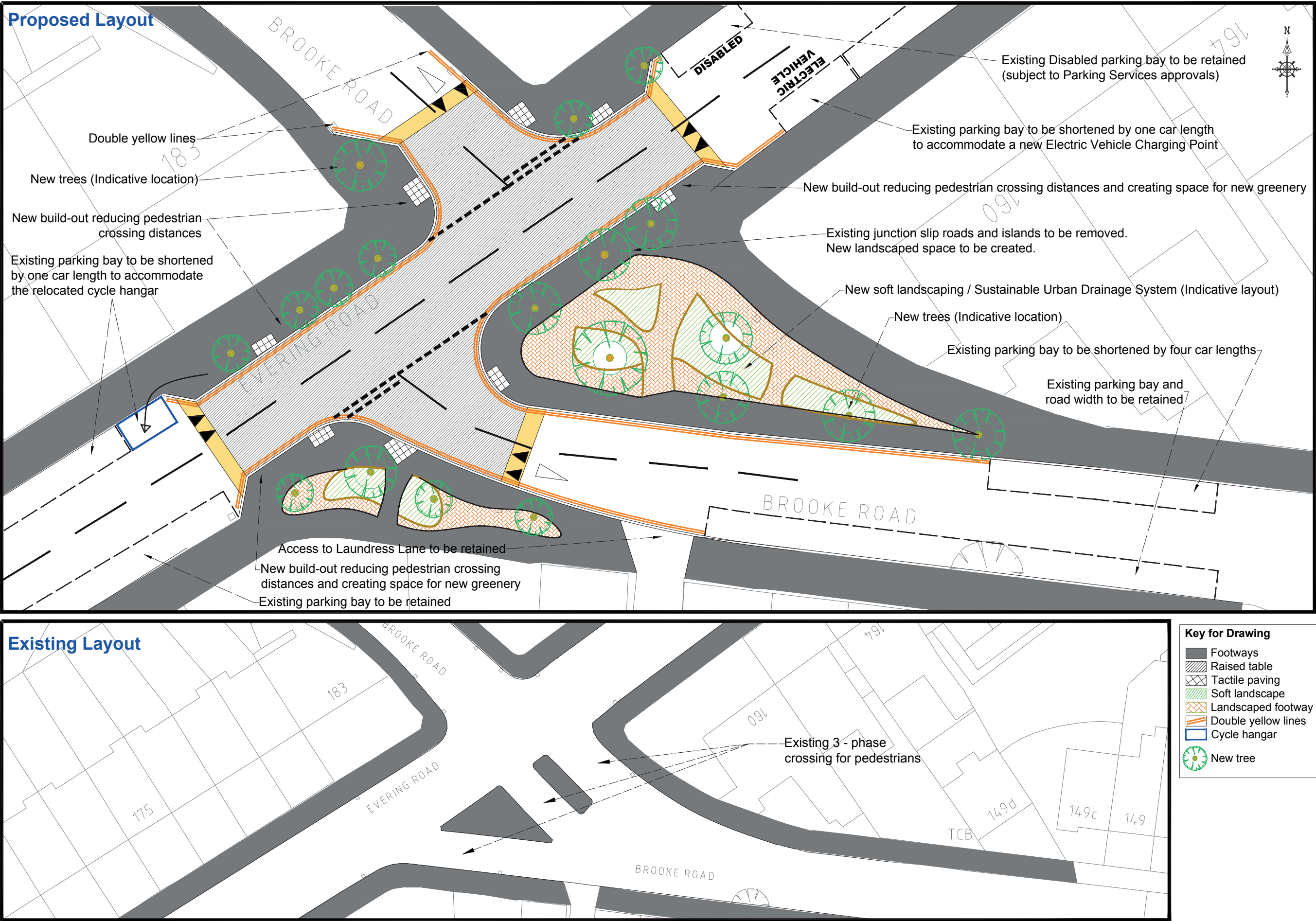

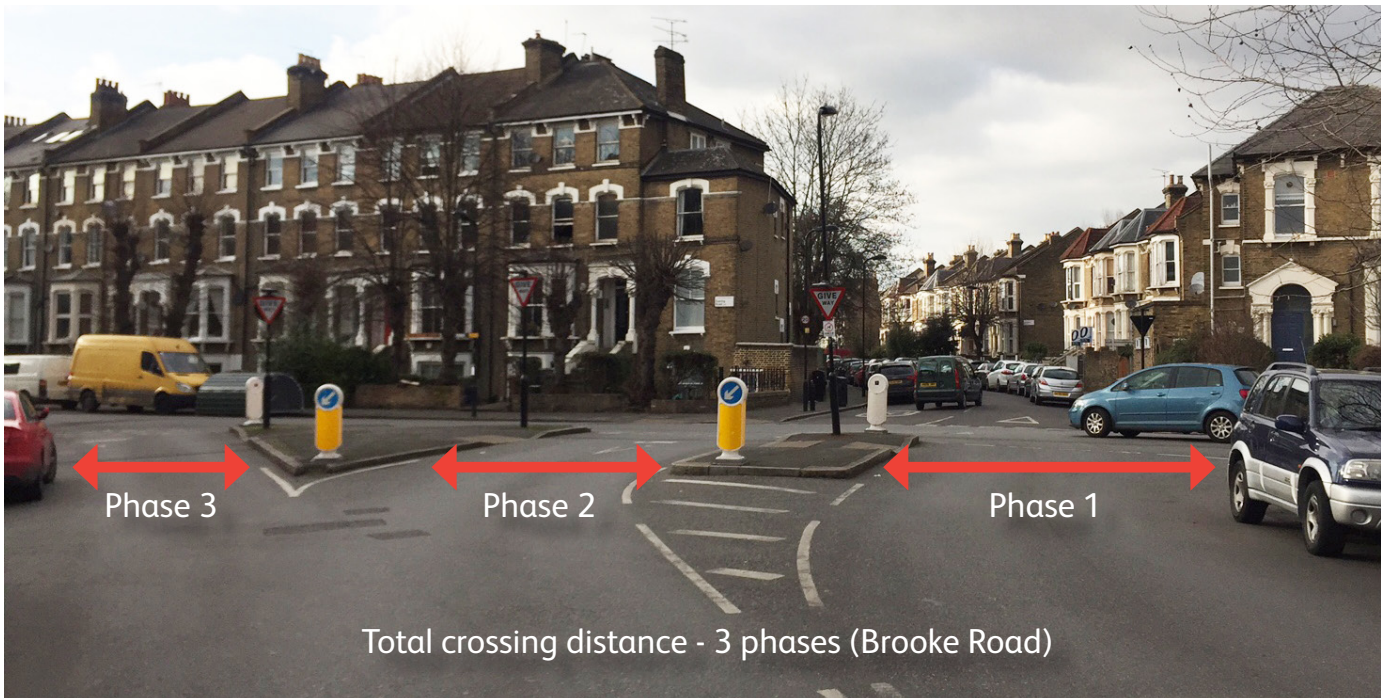

How to have your say



Your views are a very important part of our decision making process. You can have your say by returning the questionnaire provided using the **FREEPOST** envelope enclosed or by completing the online questionnaire at consultation.hackney.gov.uk by **23rd February 2020**

What happens next?

Your views will also be taken into account as part of the detailed design process. We will publish the consultation responses as well as the decisions made at consultation.hackney.gov.uk

To keep up to date with this and other plans, please visit hackney.gov.uk/street-consultations

Permanent works

We expect construction works to commence around **March 2020** with completion in **12 weeks**.

Temporary works

Pedestrian access will be maintained at all times and businesses will continue to operate. Further information regarding the works will be sent out closer to the time.

Information

For further information on these proposals, please contact us on:

Hackney Service Centre by calling: **020 8356 2897**
or by emailing: streetscene@hackney.gov.uk

If you would like to find out what this document says please tick the appropriate box, put your name, address and phone number at the bottom of this page and return it to the address below.

Bengali☐

এই দলিলে কি লেখা আছে সে সম্পর্কে যদি আপনি জানতে চান তাহলে অনুগ্রহ করে উপযুক্ত বাক্সে টিক দিন, এই পাতার নীচে আপনার নাম, ঠিকানা ও ফোন নম্বর লিখুন এবং এটি নীচের ঠিকানায় ফেরত পাঠান।

Somali☐

Haddii aad jeclaan lahayd in aad ogaato waxa dokumeentigani sheegayo fadlan calaamadi godka ku haboon, ku qor magacaaga, cinwaanka iyo telefoon lambarkaaga boggan dhankiisa hoose ka dibna ku celi cinwaanka hoose.

French☐

Si vous désirez connaître le contenu de ce document, veuillez cocher la case appropriée et indiquer votre nom, adresse et numéro de téléphone au bas de cette page et la renvoyer à l'adresse indiquée ci-dessous.

Spanish☐

Si desea saber de lo que trata este documento, marque la casilla correspondiente, escriba su nombre, dirección y número de teléfono al final de esta página y envíela a la siguiente dirección.

Kurdish☐

Ger hun dixwazin bizanibin ku ev dokument çi dibêje, ji kerema xwe qutika minasib îşaret bikin, nav, navnîşan û hejmara telefona xwe li jêrê rûpel binivîsin û wê ji navnîşana jêrîn re bişînin.

Turkish☐

Bu dökümanda ne anlatıldığını öğrenmek istiyorsanız, lütfen uygun kutuyu işaretleyerek, adınızı, adresinizi ve telefon numaranızı bu sayfanın alt kısmına yazıp, aşağıdaki adrese gönderin.

Polish☐

Jeśli chcesz dowiedzieć się, jaka jest treść tego dokumentu, zaznacz odpowiednie pole, wpisz swoje nazwisko, adres i nr telefonu w dolnej części niniejszej strony i przeslij na poniższy adres.

Vietnamese☐

Nếu bạn muốn biết tài liệu này nói gì hãy đánh dấu vào hộp thích hợp, điền tên, địa chỉ và số điện thoại của bạn vào cuối trang này và gửi lại theo địa chỉ dưới đây.

Urdu☐

اگر آپ یہ جاننا چاہتے ہیں کہ دستاویز میں کیا لکھا ہے تو ازراہ کرم مناسب باکس میں صحیح کا نشان لگائیے اور اپنا نام، پتہ اور فون نمبر اس صفحہ کے نیچے لکھئے اور اسے نیچے دیئے گئے پتہ پر واپس بھیج دیجئے۔

Chinese☐

如果你想知道這分文件的詳細內容，請在方框內打鉤，在本頁下面寫下你的名字、地址和電話號碼並寄到下面的地址。

If you would like this document in any of the following formats or in another language not listed above, please complete and send the form to the address below.

In large print

☐

In Braille

☐

On Disk

☐

On audio tape

☐

In another language, please state:

Name:

Address:

Tel:

Return to: FREEPOST STREETSCENE